

02 DECK

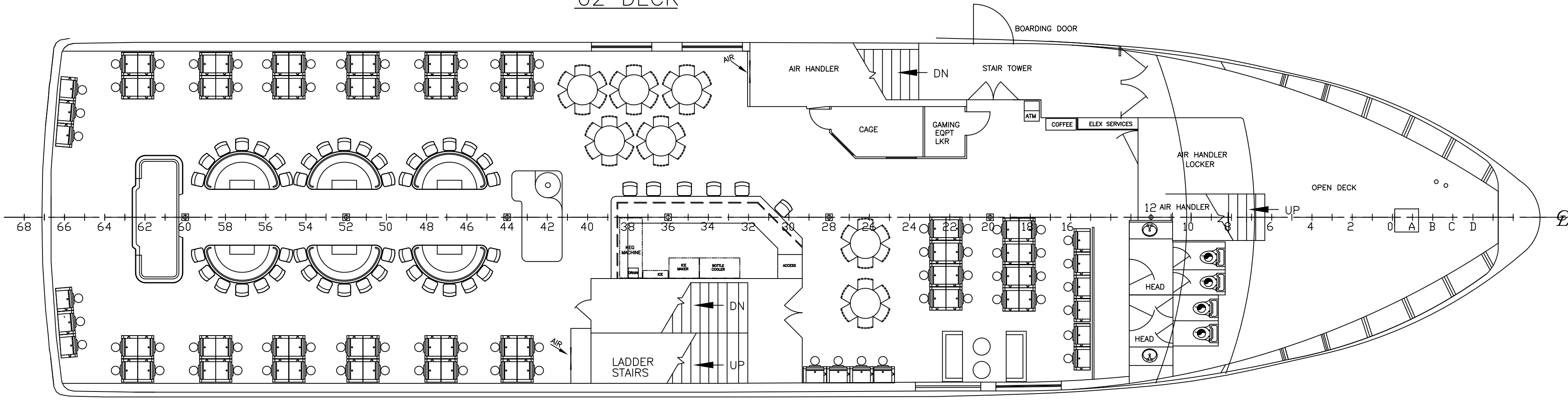

01 DECK 80 SLOTS

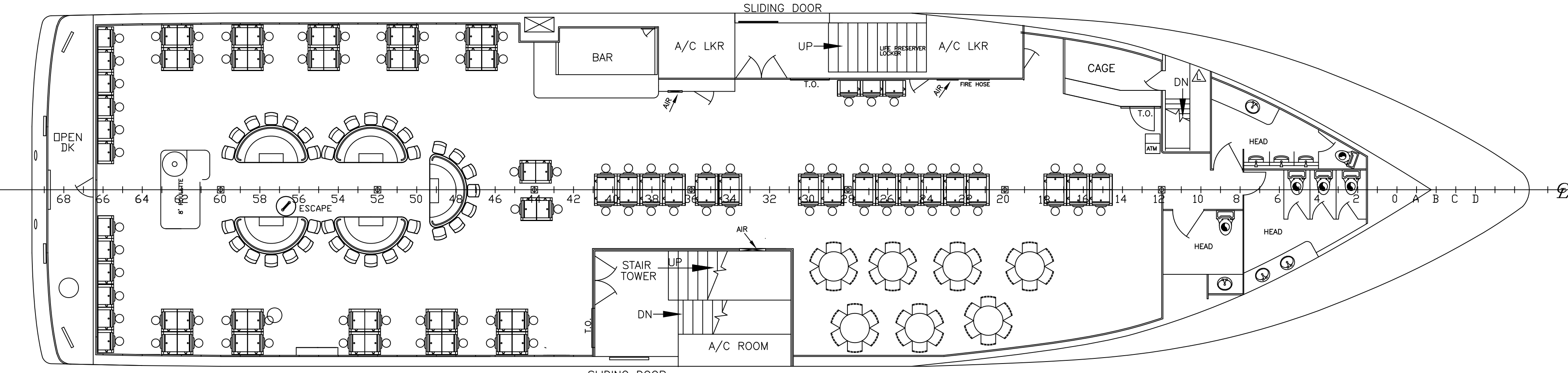

MAIN DECK 93 SLOTS

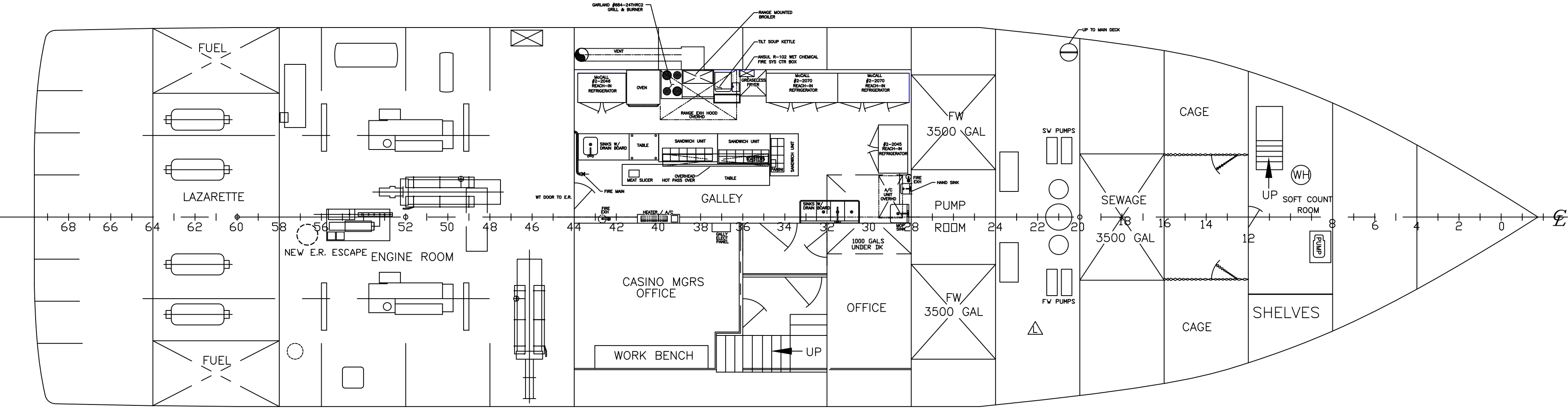

HOLD DECK

REV	ZONE	DESCRIPTION	BY	DATE
N	VAR	VAR REVS PER OWNER/SHANE COMMENTS	BWK	8/22/18
L	VAR	ADDED ENGINE ROOM ESCAPE HATCH; ADJUSTED STAIR WIDTH	LM	10/13/10
K	VAR	REV GALLEY ARR PER 201004A-3 AND SHIPCHECK; ADDED A/C LKR NEXT TO BAR ON MN DK	LM	9/15/10
J	VAR	REVISED MN DK STAIR TOWER DOOR TO MEET REF 1	BWK	8/16/10
I	VAR	VARIOUS OWNERS CHANGES AND REVS TO ADDRESS USCG COMMENTS	BWK	7/28/10
H	VAR	MODIFIED CASINO ARRGT PER OWNER	BWK	5/14/10
F	VAR	ADDED UPPER DECK BUFFETS AND MODIFIED MN DECK CASINO TABLES	BWK	4/28/10
E	VAR	VAR REVS PER SHIP CHECK / HOLD DECK	FL/RRV	4/21/10
D	ALL	VAR REVS PER SHIP CHECK	FL/RRV	4/19/10
C	ALL	VAR REVISIONS PER OWNERS COMMENTS / TEAM MTG	BWK	4/15/10
B	ALL	VAR REVISIONS PER OWNERS COMMENTS	BWK	4/14/10

REVISIONS			
NO.	DESCRIPTION	DATE	BY

REFERENCES			
NO.	DRAWING TITLE	DATE	DWG NUMBER
1	DOOR & HATCH SCHEDULE	W&D H62-C02-01	REV C

**CRUISES TO NOWHERE, LLC**

**M/V JACKS OR BETTER CASINO**

**155' DINNER CRUISE/CASINO VESSEL**

**DECK PLANS**

YARD	HULL NO.	DATE
PREPARED: BWK/TL	DATE: 04/19/10	
CHECKED:		
ENGINEER:		
APPROVED: SSA		
APPROVED: USCG		

PROJ. NO.	DRAWING NUMBER	REV
201004	201004 A-1	N

Kirilloff & Associates  
 Naval Architects & Marine Engineers  
 415 Walnut Street  
 Clearwater, FL 34615  
 USA

SCALE: 1/8" = 1'-0" & AS NOTED | SHT. 1 OF 1